



Die unglasierten einfarbigen Feinsteinzeug-Bodenfliesen der Serie Taurus COLOR stehen für die hohe Qualität unserer Produktion. Kompromisslose Qualität, vielfältige Fliesenoberflächen und zusätzliches technisches Zubehör ermöglichen den Einsatz der Fliesen nicht nur in modernen, zeitlosen Innenräumen, sondern auch in Räumen, an die höhere Funktionsansprüche gestellt werden. Die Serie umfasst auch keramische Formstücke für Sehbehinderte und Blinde.

„Unendliche Gestaltungsmöglichkeiten.“



The highly sintered unglazed single-colour tiles of the Taurus COLOR series are the benchmark of our high level production. The uncompromising quality, variety of tile surfaces, and technical supplies allow the tiles to be used not only in modern, timeless interiors but also in spaces with higher functional requirements as well. The series also includes ceramic shaped bricks for the visually impaired and blind.

„Unlimited design possibilities.“





Produkt product							
EN 14411 - G Bla	Bodenfliese floor tile	Bodenfliese floor tile	Bodenfliese floor tile	Bodenfliese floor tile	Bodenfliese floor tile	Mosaik sheet 30x30 cm mosaic sheet 30x30 cm	
cm	60x60 R	30x60 R	30x30	20x20	10x10	5x5 R	
mm	598x598x10	298x598x10	298x298x8	198x198x8	98x98x8	48x48x8	
Oberfläche surface	ABS	ABS	ABS	relief SR7	ABS	ABS	
Rutschfestigkeit slip resistance	R10/B	R10/B	R10/B	R11/B	R10/B	R10/B	
Reibungskoeffizient - trocken sliding friction coefficient - dry	$\mu \geq 0,6$	$\mu \geq 0,6$	$\mu \geq 0,6$	$\mu \geq 0,7$	$\mu \geq 0,6$	$\mu \geq 0,6$	
Farbe color							
19 Black schwarz black	TAK63019 ○ 670 m ²	TAKSE019 ○ 670 m ²	TAA34019 ○ 430 m ²	TR734019 ○ 480 m ²	TAA25019 ○ 480 m ²	TAA11019 ○ 810 m ²	TDM05019 ○ 390 Netz
07 Dark Grey dunkelgrau dark grey	TAK63007 ○ 670 m ²	TAKSE007 ○ 670 m ²	TAA34007 ○ 430 m ²	TR734007 ○ 480 m ²	TAA25007 ○ 480 m ²	TAA11007 ○ 810 m ²	TDM05007 ○ 390 Netz
06 Grey grau grey	TAK63006 ○ 560 m ²	TAKSE006 ○ 560 m ²	TAA34006 ○ 410 m ²	TR734006 ○ 460 m ²	TAA25006 ○ 470 m ²	TAA11006 ○ 810 m ²	TDM05006 ○ 390 Netz
03 Light Grey hellgrau light grey	TAK63003 ○ 710 m ²		TAA34003 ○ 430 m ²	TR734003 ○ 480 m ²	TAA25003 ○ 480 m ²	TAA11003 ○ 810 m ²	TDM05003 ○ 390 Netz
11 White weiß white	TAK63011 ○ 820 m ²		TAA34011 ○ 620 m ²		TAA25011 ○ 550 m ²	TAA11011 ○ 850 m ²	TDM05011 ○ 420 Netz
10 Ivory elfenbein ivory	TAK63010 ○ 560 m ²		TAA34010 ○ 410 m ²	TR734010 ○ 460 m ²	TAA25010 ○ 470 m ²	TAA11010 ○ 810 m ²	TDM05010 ○ 390 Netz
25 Tobacco braun-grau brown-grey	TAK63025 ○ 670 m ²		TAA34025 ○ 430 m ²	TR734025 ○ 480 m ²	TAA25025 ○ 480 m ²	TAA11025 ○ 810 m ²	TDM05025 ○ 390 Netz
logistische Daten logistic information							
	3	6	14	32	12	4	
St/m ²	2,8	5,6	11,0	25,0	11,0	11,0	
m ²	1,08	1,08	1,27	1,28	1,09	0,36	
m ²	32	40	48	54	56	-	
m ²	34,56	43,20	60,96	69,12	61,04	-	
kg	23,7	23,7	21,6	21,8	18,5	6,0	
kg/m ²	21,9	21,9	17,0	17,0	17,0	17,0	
brutto kg	782	971	1 062	1 200	1 063	-	



Produkt product							
STO No. 030-059824	Stufe step tile	Sicherheitsstufenprofil step piece with riser	Spezielle keramische Formteile special floor tile		Stufe step tile	Socket skirting plinth	Socket skirting plinth
	30×60 R	60×5 R 60×2	30×30		30×30	60×9,5 R	30×8
	298×598×10	598×50×10 598×20×10	298×298×9		298×298×8	598×95×10	298×80×8
Oberfläche surface	ABS	ABS	relief go	relief stop	ABS	ABS	ABS
Rutschfestigkeit slip resistance	R10/B	R10/B	R11/A	R11/A	R10/B		
Reibungskoeffizient - trocken sliding friction coefficient - dry	$\mu \geq 0,7$	$\mu \geq 0,7$	$\mu \geq 0,7$	$\mu \geq 0,7$	$\mu \geq 0,7$		
barva color							
19 Black schwarz black	TCPSE019 ○ 370 St	TCPVN019 ○ 530 set	TTG35019 ○ 500 St	TTS35019 ○ 500 St	TCP34019 ○ 170 St	TSASZ019 ○ 220 St	TSAKF019 ○ 140 St
07 Dark Grey dunkelgrau dark grey	TCPSE007 ○ 370 St				TCP34007 ○ 170 St	TSASZ007 ○ 220 St	TSAKF007 ○ 140 St
06 Grey grau grey	TCPSE006 ○ 370 St				TCP34006 ○ 170 St	TSASZ006 ○ 220 St	TSAKF006 ○ 140 St
03 Light Grey hellgrau light grey	TCPSE003 ○ 370 St				TCP34003 ○ 170 St	TSASZ003 ○ 220 St	TSAKF003 ○ 140 St
11 White weiß white	TCPSE011 ○ 390 St				TCP34011 ○ 180 St	TSASZ011 ○ 250 St	TSAKF011 ○ 150 St
10 Ivory elfenbein ivory	TCPSE010 ○ 370 St	TCPVN010 ○ 530 set	TTG35010 ○ 500 St	TTS35010 ○ 500 St	TCP34010 ○ 170 St	TSASZ010 ○ 220 St	TSAKF010 ○ 140 St
25 Tobacco braun-grau brown-grey	TCPSE025 ○ 370 St				TCP34025 ○ 170 St	TSASZ025 ○ 220 St	TSAKF025 ○ 140 St
logistická data logistic information							
	6	16	9		13	13	23
	5,6	-	11,0		11,0	17,5	42,0
	1,08	-	0,81		1,18	0,74	0,55
	40	-	42		52	-	-
	43,20	-	34,36		61,36	-	-
	23,7	15,2	18,0		19,5	16,2	9,4
	21,9	21,9	22,2		17,0	21,9	17,0
	971	-	780		1 039	-	-

Hohlkehlssocket cove skirting	Hohlkehlssocket cove skirting	Innenecke Hohlkehlssocket inside corner cove skirting	Außenecke Hohlkehlssocket outside corner cove skirting	Duschasseneckstein shower piece corner	Duschassenstein shower piece continuous
30×8	20×8	2,3×8	2,3×8	10×10	10×10
298×80×8	198×80×8	80×23×10	80×23×7	98×98×8	98×98×8
ABS	ABS	S	S	ABS	ABS
R10/B	R10/B			R10/B	R10/B
$\mu \geq 0,6$	$\mu \geq 0,6$			$\mu \geq 0,6$	$\mu \geq 0,6$
TSPKF019 ○ 140 St	TSPF6019 ○ 120 St	TSIRH019 ○ 200 St	TSERH019 ○ 200 St	TTR11019 ○ 200 St	TTP11019 ○ 200 St
TSPKF007 ○ 140 St	TSPF6007 ○ 120 St	TSIRH007 ○ 200 St	TSERH007 ○ 200 St	TTR11007 ○ 200 St	TTP11007 ○ 200 St
TSPKF006 ○ 140 St	TSPF6006 ○ 120 St	TSIRH006 ○ 200 St	TSERH006 ○ 200 St	TTR11006 ○ 200 St	TTP11006 ○ 200 St
TSPKF003 ○ 140 St	TSPF6003 ○ 120 St	TSIRH003 ○ 200 St	TSERH003 ○ 200 St	TTR11003 ○ 200 St	TTP11003 ○ 200 St
TSPKF010 ○ 140 St	TSPF6010 ○ 120 St	TSIRH010 ○ 200 St	TSERH010 ○ 200 St	TTR11010 ○ 200 St	TTP11010 ○ 200 St
TSPKF025 ○ 140 St	TSPF6025 ○ 120 St	TSIRH025 ○ 200 St	TSERH025 ○ 200 St	TTR11025 ○ 200 St	TTP11025 ○ 200 St
19	28	150	100	16	16
42,0	62,5	-	-	100,0	100,0
0,46	0,45	-	-	0,16	0,16
-	-	-	-	-	-
-	-	-	-	-	-
7,8	7,6	4,5	3,5	3,5	3,2
17,0	17,0	-	-	-	-
-	-	-	-	-	-



Farben | colors

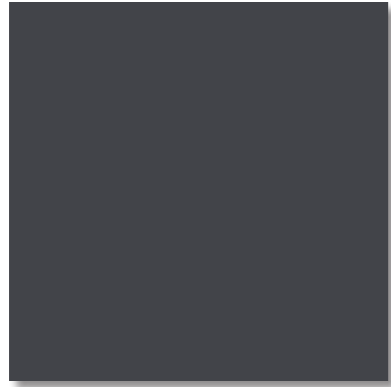
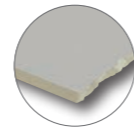

19 Black
schwarz | black



07 Dark Grey
dunkelgrau | dark grey



06 Grey
grau | grey

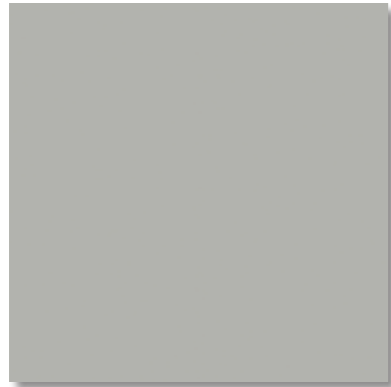

03 Light Grey
hellgrau | light grey

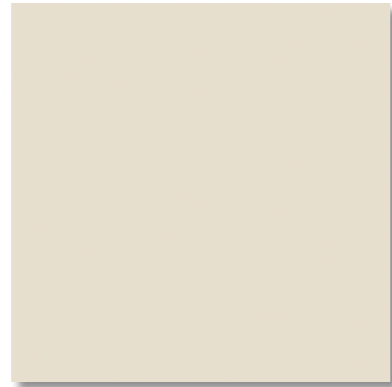

11 White
weiß | white

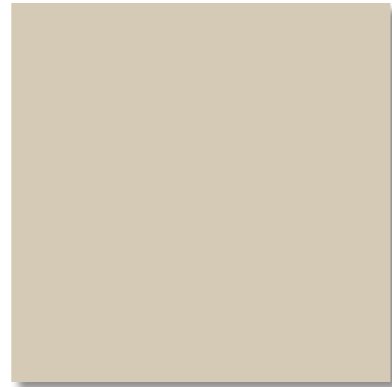

10 Ivory
elfenbein | ivory



25 Tobacco
braun-grau | brown-grey



Oberflächen | surfaces



ABS



relief
SR7

R10/B
 $\mu \geq 0,6$

R11/B
 $\mu \geq 0,7$



Stufe | step tile | TCPSE... | 298x598x10 mm |

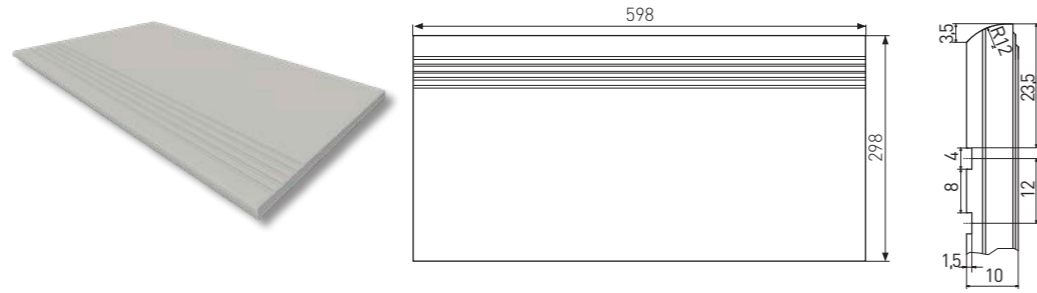

Stufe | step tile | TCP34... | 298x298x8 mm |



Socket | skirting plinth | TSASZ... | 598x95x10 mm |

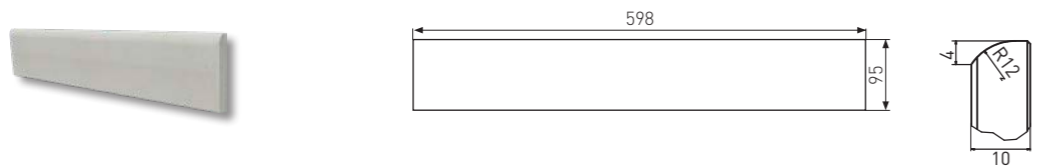

Socket | skirting plinth | TSAKF... | 298x80x8 mm |

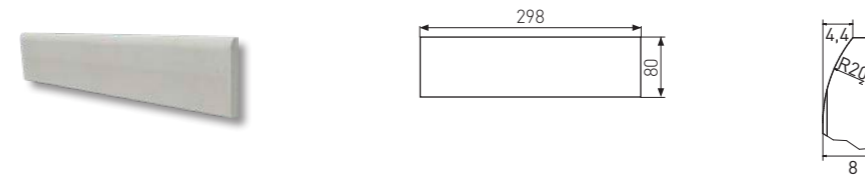

Hohlkehsocket | cove skirting | TSPKF... | 298x80x8 mm |

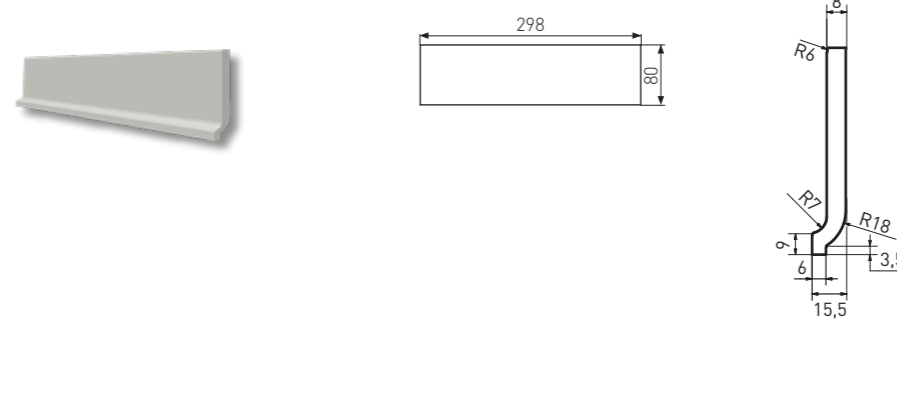

Hohlkehsocket | cove skirting | TSPF6... | 198x80x8 mm |

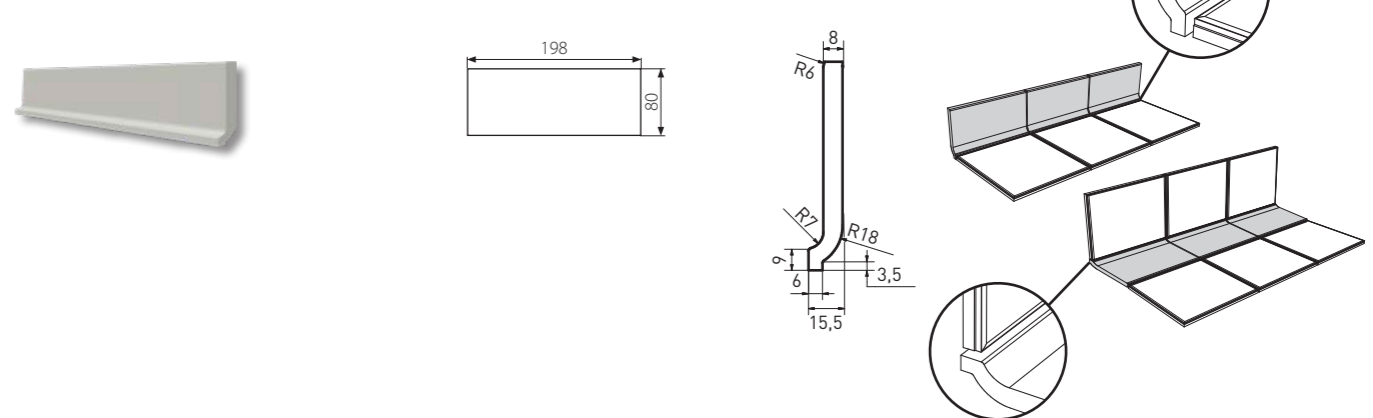



Innenecke Hohlkehlssockel | inside corner cove skirting | **TSIRH...** | 23x80x10 mm

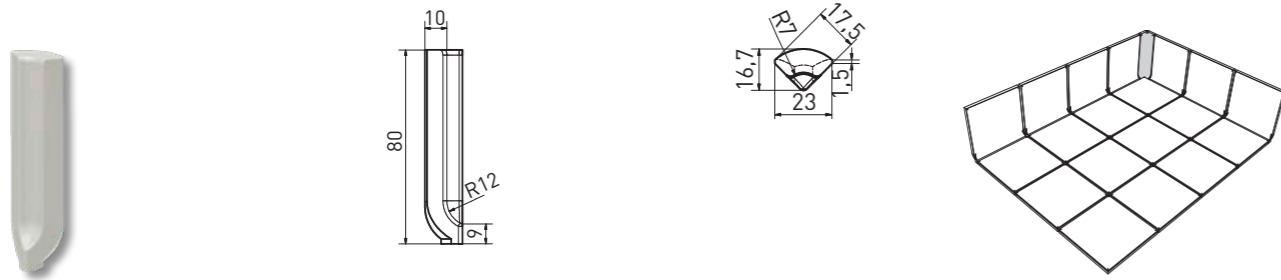

Außenecke Hohlkehlssockel | outside corner cove skirting | **TSERH...** | 23x80x7 mm

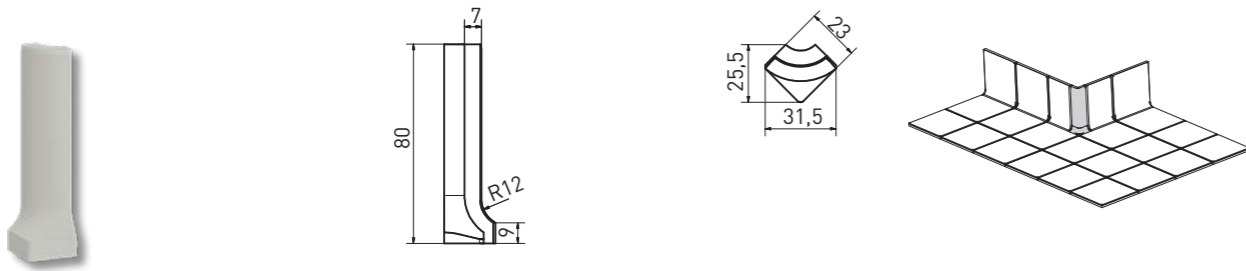

Duschtasseneckstein | shower piece - corner | **TTR11...** | 98x98x8 mm |

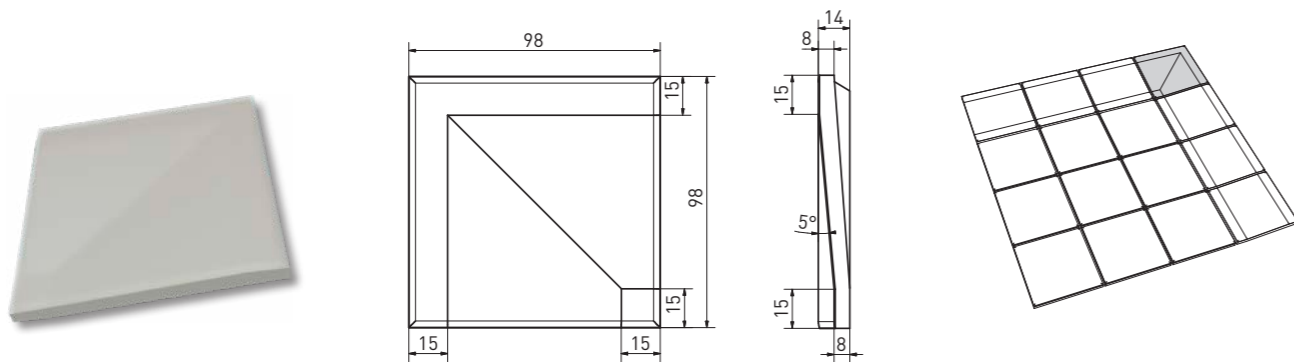

Duschtassenstein | shower piece - continuous | **TTP11...** | 98x98x8 mm |

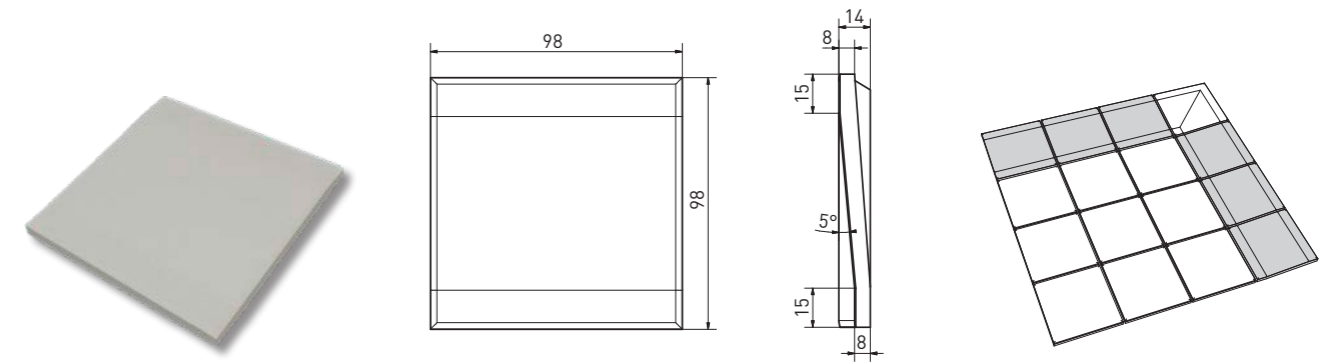

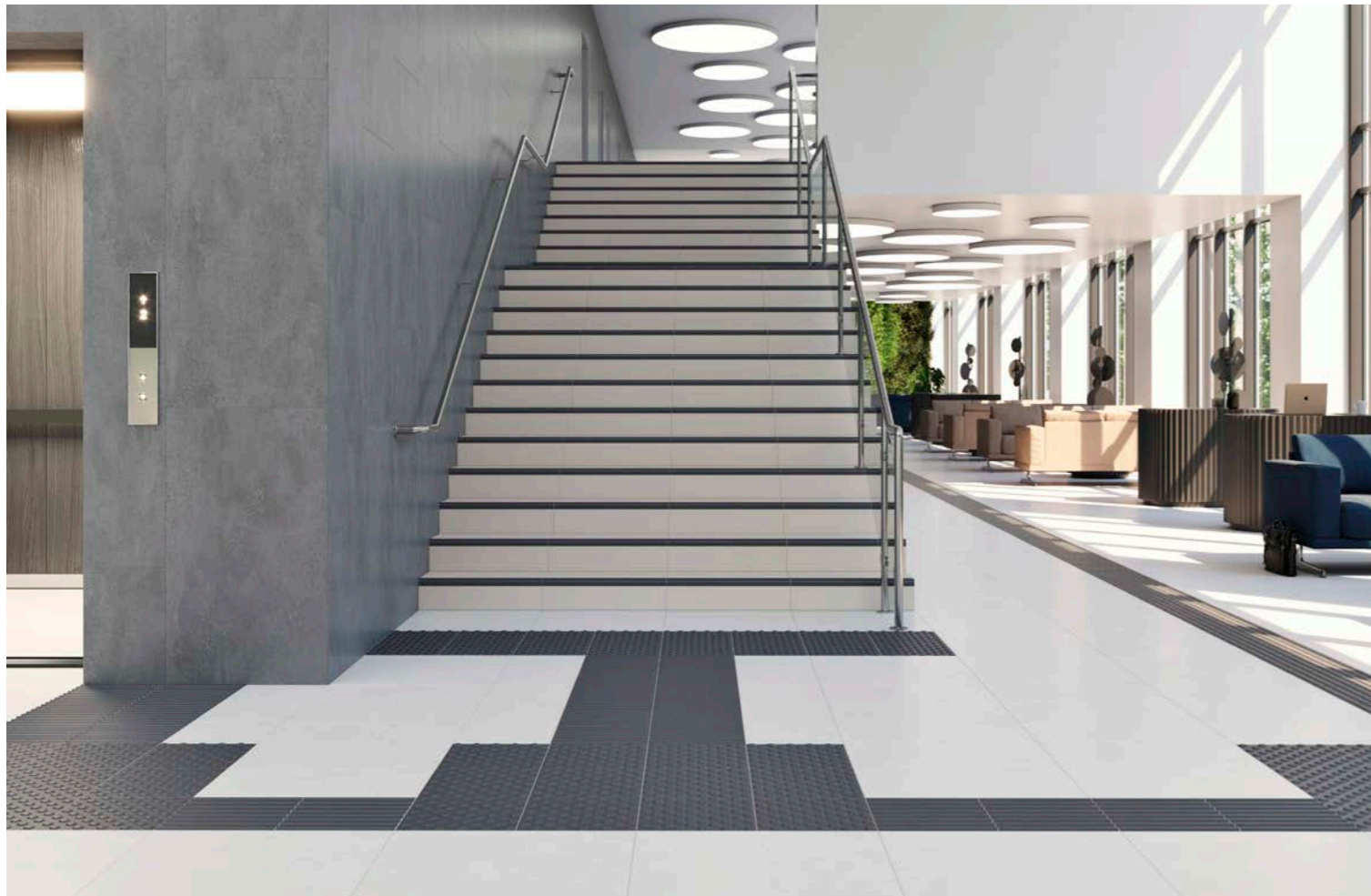
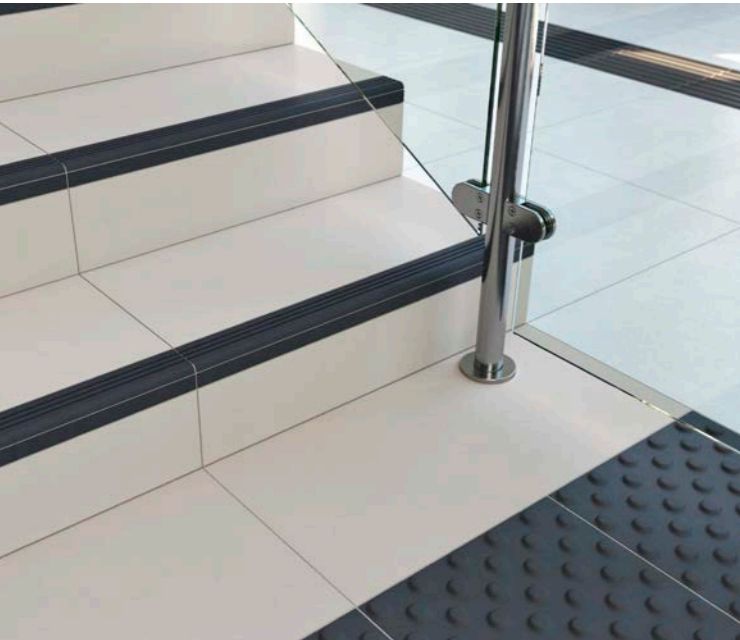
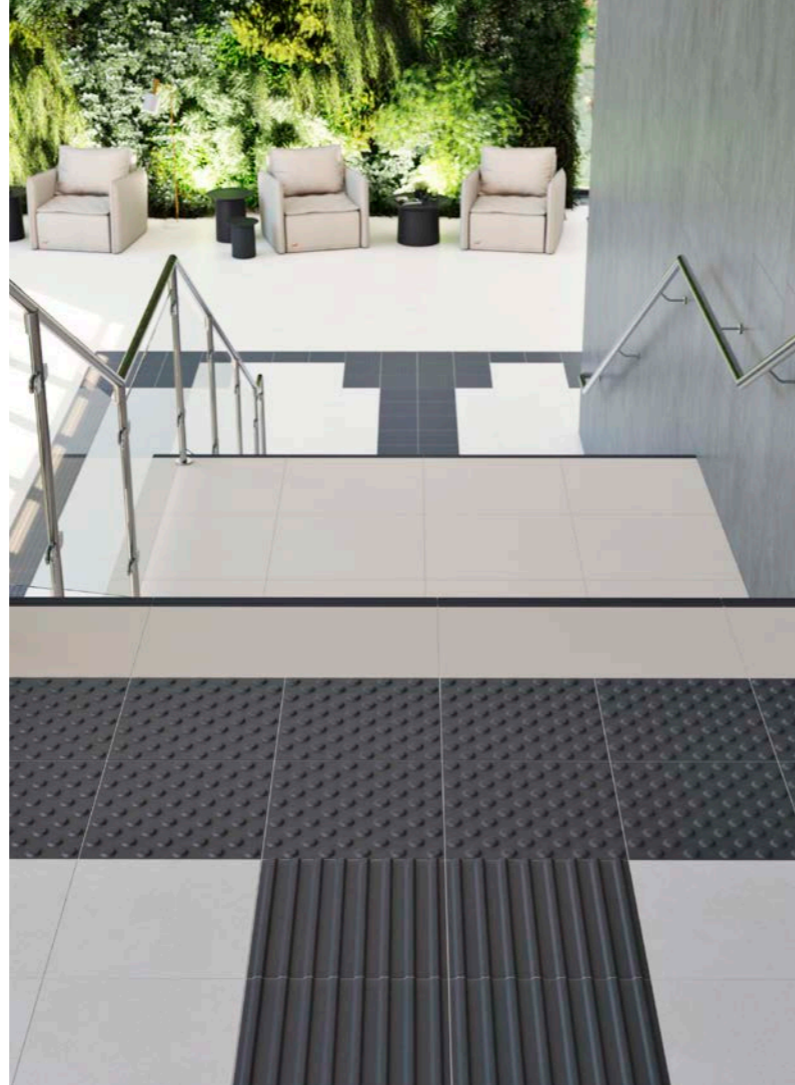

Sicherheitsstufenprofil | step piece with riser | **TCPVN...** | 598x50x10 mm | 598x20x10 mm |

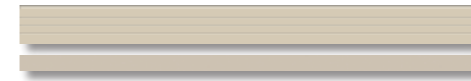

TCPVN010



TCPVN019

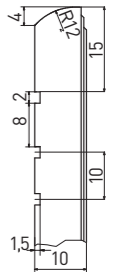
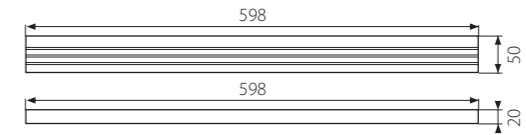
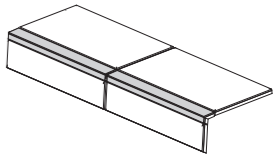

Spezielle keramische Formteile für Sehschwache und Blinde | special ceramic shaped tiles for the visually impaired persons

relief go



TTG35010



TTG35019

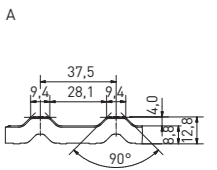

relief stop

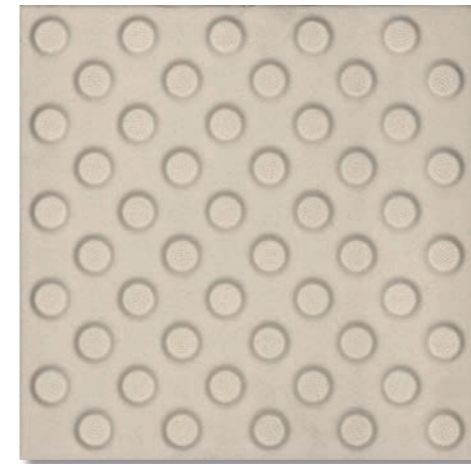

TTS35010

elfenbein | ivory

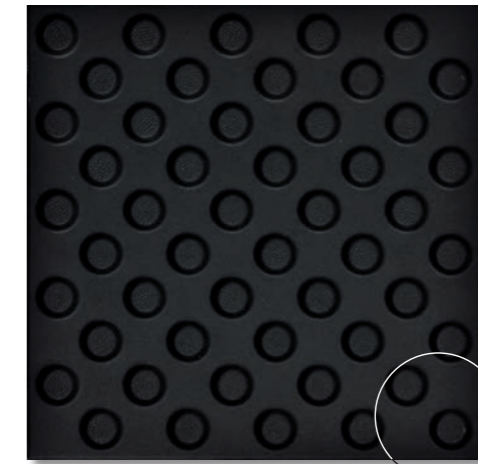

TTS35019

schwarz | black

